



P
resbytery of

G
reater

A
tlanta

News

Together, we are Christ's Body

VOLUME 2, ISSUE 3

JULY 25, 2003

Charles Easley Chosen as Vice Moderator of the Presbyterian Church USA

-Cassandra Morrow, Associate Executive Presbyter for Mission and Institutions

<http://www.pcusa.org/ga215/news/ga03023.htm>

Charles Easley, an elder and member of Radcliffe Presbyterian Church – Presbytery of Greater Atlanta, was appointed Vice Moderator of the 215th General Assembly.

The Rev. Susan R. Andrews, disclosed her choice during Monday morning's annual General Assembly Breakfast. Charles, an African-American, retired college administrator, now serves as Vice-President of Sheltering Arms Day Care System in Atlanta, a

network of 20 day care centers. He's a member of the General Assembly Council, and also has served as national president of Presbyterian Men. "I come with no agenda, no stump, other than I love this church," he said. Easley, a native of Dalton, GA, said he grew up "Bapterian." "There were two small churches in his community. The



Photo by Danny Bolin.

Baptist church held services on the first and third Sundays of each month, the Presbyterian church on the second and fourth. We went to all of them," he said.

During a press conference after the breakfast meeting, Easley characterized himself as "an eternal optimist," and said a great strength of the PC(USA) is that "things bubble up from the grass roots."

He said he appreciates the Moderator's "common touch" as a parish pastor, and agreed with much of

what she said during the election process.

Charles Easley served as the Interim Associate Executive Presbyter for Mission and Institutions with the Presbytery of Greater Atlanta for approximately two years. He is currently moderator elect, and will become moderator for PGA in fall 2004.

Summer Presbytery Meeting Highlights —Ed Albright, Executive Presbyter

The Presbytery of Greater Atlanta had a wonderful summer meeting on the campus of Agnes Scott College. The meeting was held at a new time, 4:00 to 9:00 p.m. This was an attempt to see if elders who normally cannot attend on a weekday or a Saturday could more easily come to an evening meeting. The new time for this weekday

meeting seemed to be a success for all.

The following are highlights:

- ◆ The Presbytery enrolled as candidates three persons: *Carol Scott Wade* a member of North Avenue

(Continued on page 8)

INSIDE THIS ISSUE:

2003 Fall Leadership Event	2
APA Regional Conference	7
PGA Approves Candidates	8
Presbytery Meeting Highlights	8
New Clergy	9
New Health Privacy Regulations	12
2003 Presbytery Directories	16



...MARK YOUR CALENDARS... 2003 PRESBYTERY MEETING DATES

September 27, 2003
Saturday, 10:00 am
Newnan Trinity

December 2, 2003
Tuesday, 10:00 am
Korean Community

*Please note the change in location.

Register by August 8 for the Fall Leadership Event

—Forrest Palmer, Associate Executive for Congregational Support

This year's three-presbytery (Greater Atlanta, Cherokee and Northeast Georgia) "Fall Leadership Event" is shaping up to be the largest (and maybe best?) ever, with 70 workshops being offered!

Date: Saturday, August 16, 2003
Location: Peachtree Presbyterian Church (3434 Roswell Road, NW)
Times: Registration begins at 8 a.m.; Keynote at 9:15 a.m.; Workshops at 10:15 a.m. and 1:30 p.m.

Registration forms and all event material may be found on our presbytery web page (<http://presbyteryofgreateratl.org>)

Register early to receive the lowest price! Churches may register as a group for the lowest price, prior to August 8 through the "church maximum" discount being offered. The fee schedule rises after August 8 and no group discount is offered after August 8, to allow the presbyteries time to prepare the needed materials for the event and to give Peachtree Presbyterian meal numbers and child care numbers by the dates they need them in order to prepare.

The keynote speaker for this year's event is Rodger Nishioka, assistant professor at Columbia Theological Seminary. Rodger is widely known for his enthusiasm and his work in youth and young

adult ministry over the years as the denomination staff person in charge of that area. Rodger's keynote theme is "Strike the Rock" (Exodus 17: 1-7).

The Fall Leadership Event is for ALL congregational leaders - Sunday School teachers, youth advisors, Presbyterian Women, church officers, pastors, educators.... Each year, this event brings together many wonderful workshop leaders in an effort to help our congregational leaders be the best they can be as leaders. The event is always the third Saturday in August each year. Get your congregational leaders to sign up NOW -- and before the August 8 deadline! See you there!

Help PATH and Calvin Center Build a House for Fahed!!

—Sarah Humphrey, PATH Director

The Reverend Fahed Abu-Akel has just finished his year as Moderator of the Presbyterian Church (USA) and in honor of his faithful service to the Church we are building a Palestinian house and garden area in the Global Village at Calvin Center (a joint project of PATH and Calvin Center). Designed by architect and friend of Fahed, Haitham Haddad, the house will be built to represent a traditional Palestinian home. After construction the house will become part of the Global Village program - a real life, real world experience into the realities of hunger and poverty around the world. To date construction has

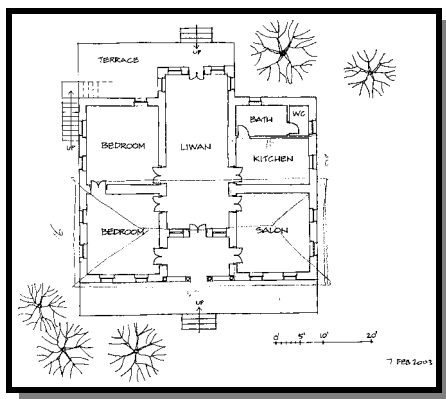

been completed on a Haitian house and outdoor kitchen. Future construction will include Nicaraguan and Kenyan houses. Funds are needed to help us finish construction of "Fahed's House". We invite you and your

congregation to help us honor Fahed by making a donation to PATH for the Global Village. Buy a building block, window or entire room! Estimated total construction costs will be \$25,000. Donors will be recognized at the house's dedication party after construction is complete. Please call Sarah Humphrey, 404 228-7728 or John Hicks, 770 946-4276 x23 if you have any questions about "Fahed's House" or the Global Village. Donations should be made to Presbyterian Answer to Hunger (PATH), marked Global Village and sent to PATH, 1328 Peachtree St., NE, Atlanta, GA 30309.